

Ebbe Unique Drain Cover Installation & Removal Guide

IMPORTANT! Allow grout to cure for 24 hours before removing the Construction Plug

Step 1 – Remove Construction Plug

- Push down on the center of the Plug 2-3 times to separate it from the grout
- Thread a screw into one of the four corner holes
- Pull up on the screw to remove the Construction Plug

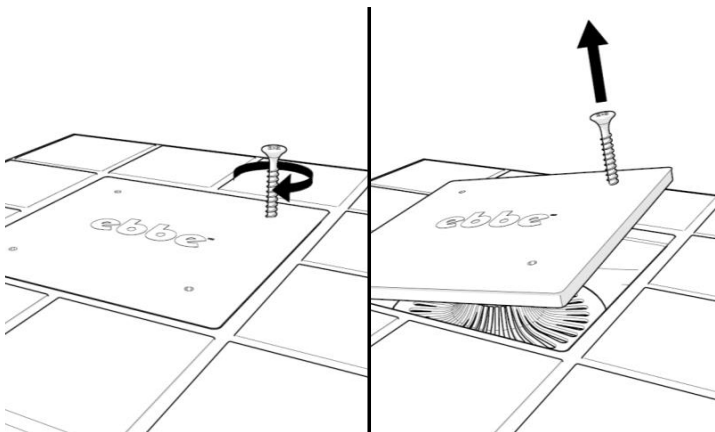

Step 2 – Install Drain Cover

- Remove any debris from inside the riser, and cover seat
- The Hair Trap should be positioned with the tines facing up
- Install the Unique Cover and push down until it's completely seated

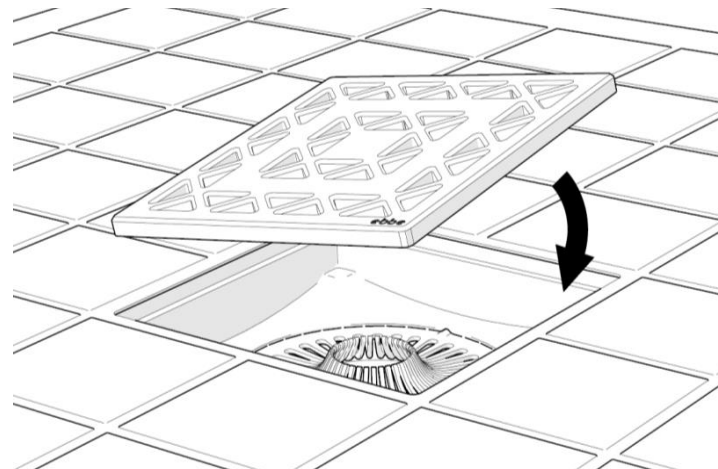

Step 3 – Removing Cover for Cleaning

- Insert the J-hook of the Unique Cover Remover through a hole in the cover and pull up.
- **NOTICE:** To protect your tile from damage, place a towel around the cover during removal.
- Remove the cover
- Clean the Riser and Cover with any non-abrasive cleaner.
- Replace the Hair Trap if necessary

